

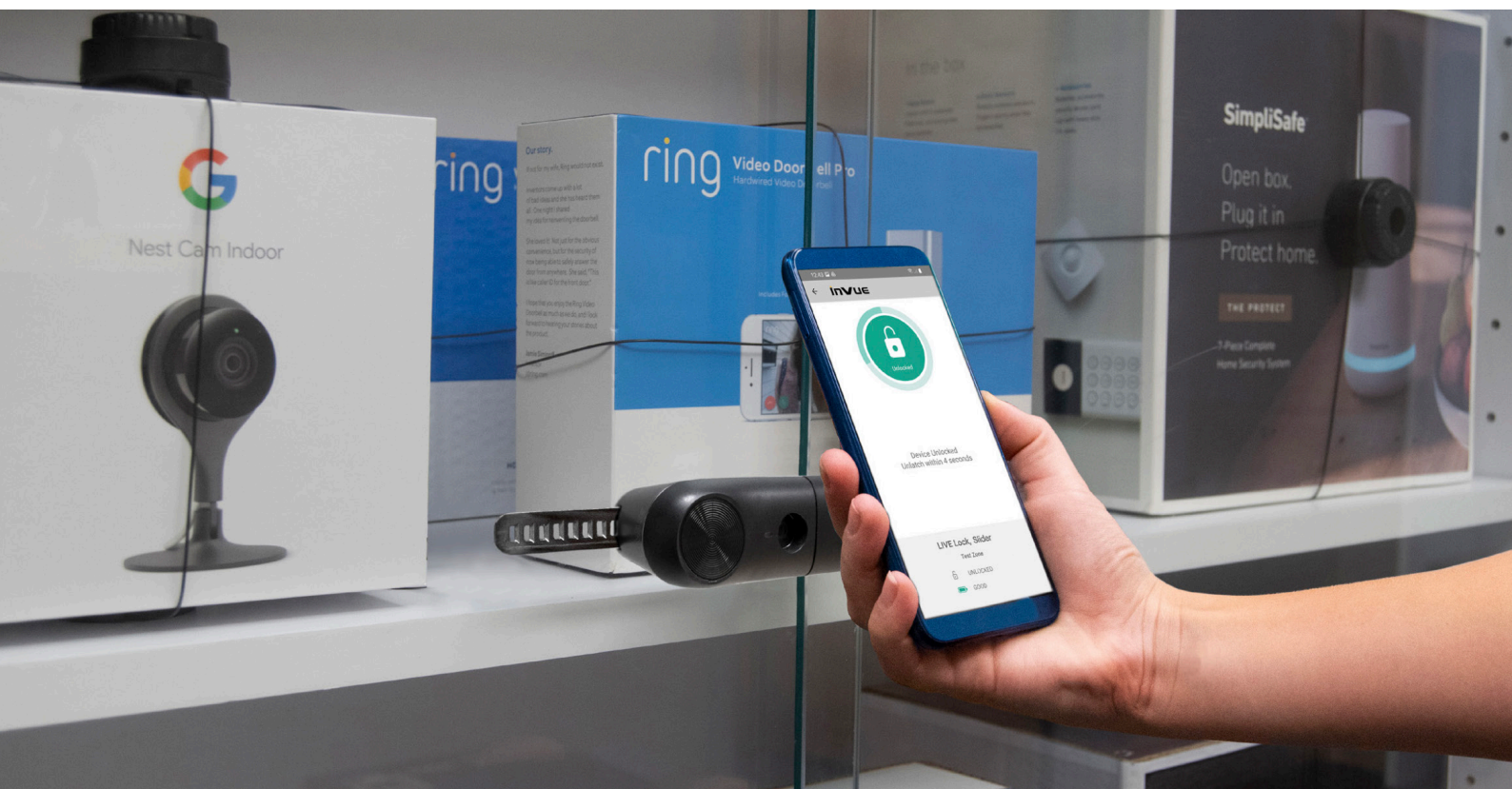

LIVE Locks

Secure access in a single tap.



LIVE Locks offer secure, streamlined, and full management of locked merchandise to make servicing customers easy.

FLEXIBLE

The widest variety of locking technologies for future proof applications.

ONE LESS KEY

Manage access digitally with a single key for easy operations and seamless service.

ANALYTICS & REPORTING

Manage access, zone permissions and audit activity in real time.

EXCLUSIVELY DISTRIBUTED IN AUSTRALIA BY SABEL

Visit www.sabel.com.au • P 1300 551 662 • E sales@sabel.com.au

SABEL

Features and Benefits

- 1 Supports NFC, Bluetooth or 2D barcode
- 2 No local wiring
- 3 2-year battery life
- 4 Remote unlock capability*
- 5 Uses InVue's LIVE Access to operate
- 6 Compatible with existing OneKEY

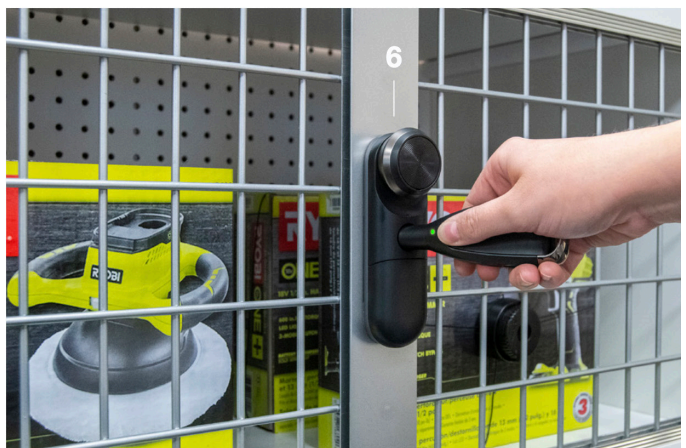
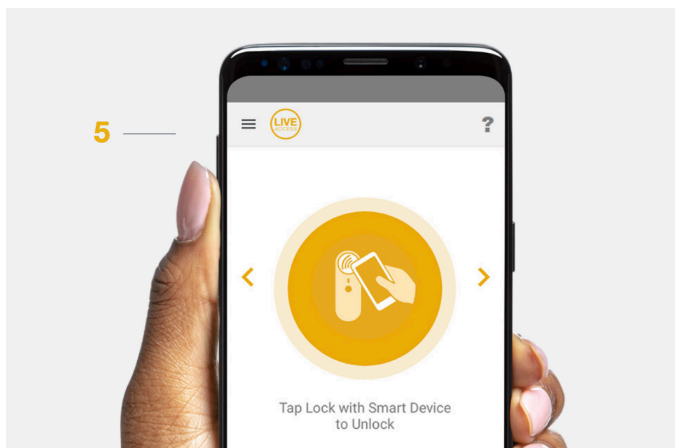
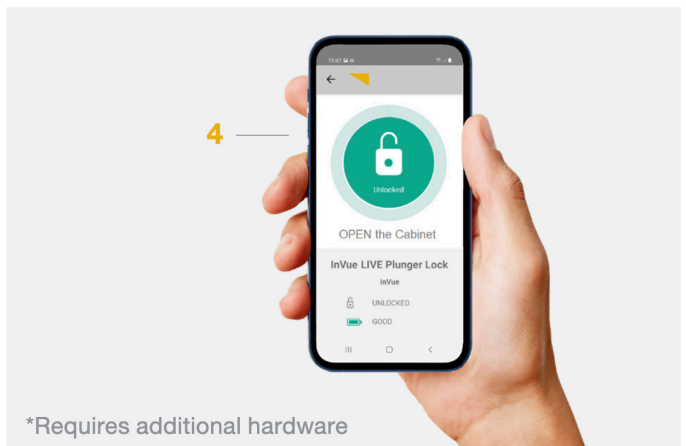

LIVE Lock Configurations



LIVE Plunger Lock



LIVE Cam Lock



LIVE Slider Lock

LIVE Locks together with InVue's **LIVE Access** software equips daily operators and corporate strategists with real-time control and actionable insights across your enterprise.

For Daily Operations:

- ✓ Intuitive mobile app to lock, unlock, and relatch each device
- ✓ Summary and status of all locks

For Enterprise Strategy:

- ✓ Cloud-based, single sign-on dashboard
- ✓ Summary of products and activity
- ✓ Audit and report by location, department, and user

©2025 InVue Security Products. No endorsement of InVue products has been made by any of the manufacturers of the products shown. Product is sold pursuant to InVue's warranty which can be found at invue.com/warranty.

Part of ASSA ABLOY Group

EXCLUSIVELY DISTRIBUTED IN AUSTRALIA BY SABEL

Visit www.sabel.com.au • P 1300 551 662 • E sales@sabel.com.au

SABEL