



## OnePOD Max

# Authentic Experience. Maximum Security.



**Give customers the freedom to engage—without compromising security.**

OnePOD Max empowers customers to explore freely with secure, quick-release brackets while your team benefits from streamlined operations—all with InVue's most secure display solution yet.

### ENGAGED TO SELL

Enable secure, hands-on demos that let customers hold devices untethered to make confident buying decisions.

### SIMPLIFY OPERATIONS

Create any display, reset in seconds—no tools, no hassle—so your team stays focused on customers.

### REDEFINE SECURITY

Protect high-value devices with our strongest display yet—complete with access control and tracking.

**EXCLUSIVELY DISTRIBUTED IN AUSTRALIA BY SABEL**

Visit [www.sabel.com.au](http://www.sabel.com.au) • P 1300 551 662 • E [sales@sabel.com.au](mailto:sales@sabel.com.au)

# SABEL



OnePOD Max solves retail's toughest challenge—delivering top-tier customer experiences without compromising security.

## FEATURES AND BENEFITS

1. Compatible with phones—including flip and folds—tablets, and wearables to showcase a fully branded ecosystem.
2. Mounts to tables or walls utilizing front or reverse display to showcase top features like high-end cameras and finishes.
3. Open with the InVue OneKEY app or with our OneKEY for quick, secure access.
4. Monitor device status, track events, manage user roles, and access reporting—all in one platform for better oversight and control.
5. Low-profile charge connectors and no external security for wearables create a sleek, touchable experience shoppers love.
6. Brackets automatically lock when a device is detected—no extra steps.

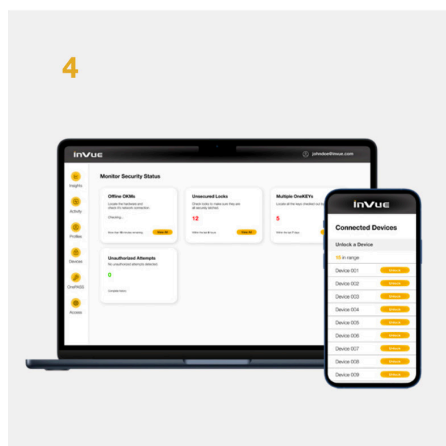
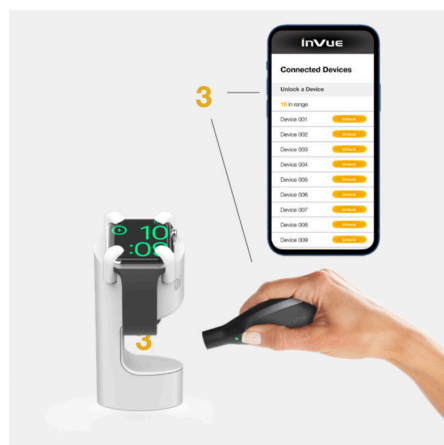

©2025 InVue Security Products. No endorsement of InVue products has been made by any of the manufacturers of the products shown. Product is sold pursuant to InVue's warranty which can be found at [invue.com/warranty](https://www.invue.com/warranty).

Part of ASSA ABLOY Group

**EXCLUSIVELY DISTRIBUTED IN AUSTRALIA BY SABEL**

Visit [www.sabel.com.au](https://www.sabel.com.au) • P 1300 551 662 • E [sales@sabel.com.au](mailto:sales@sabel.com.au)

**SABEL**